

48" x 96" VAULT ASSEMBLY

48" DEPTH / TORSION ASSIST



POLYMER CONCRETE

ARMORCAST PRODUCTS COMPANY

A6001449MT

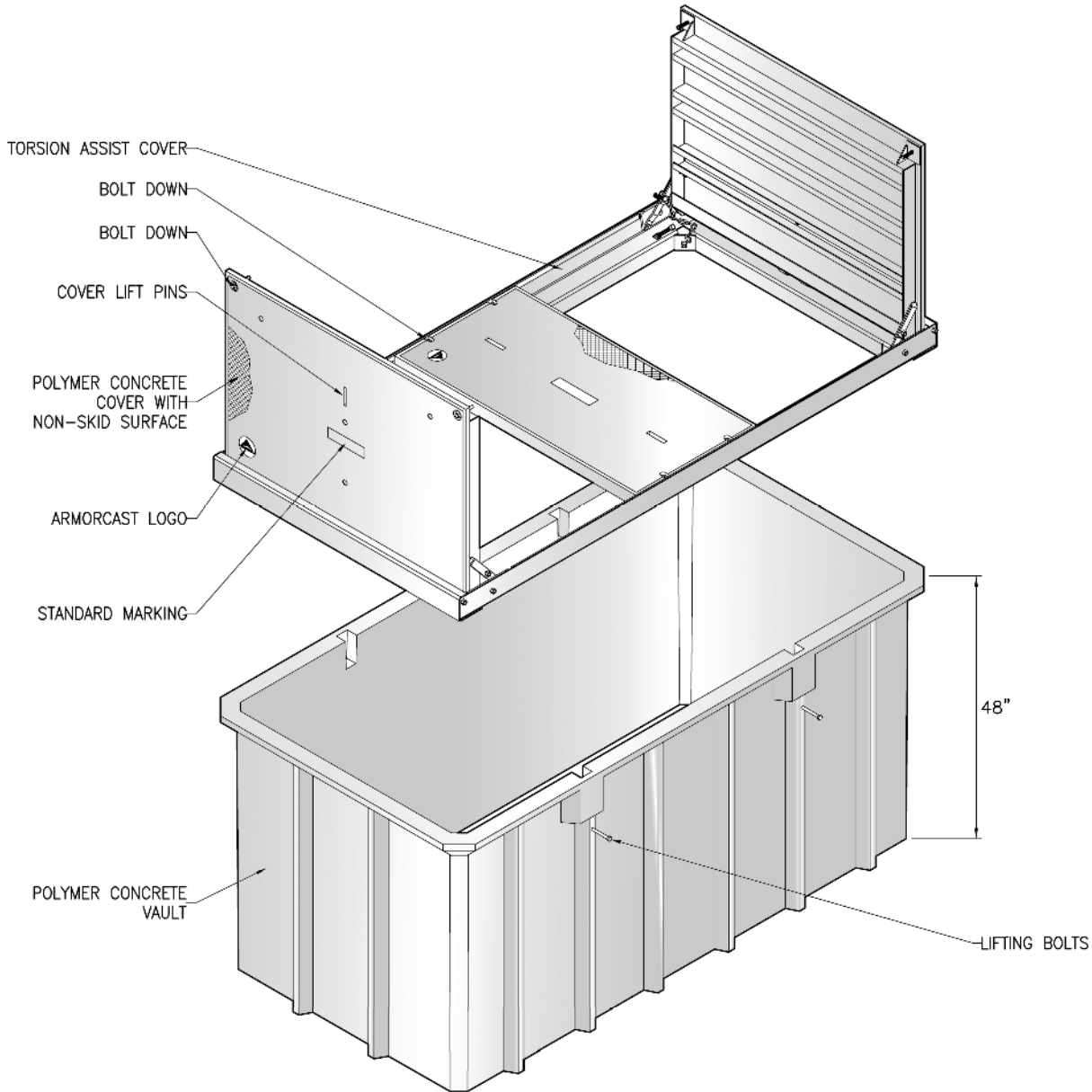

POLYMER CONCRETE VAULTS & MANHOLE

48"W x 96"L VAULT ASSEMBLY / TORSION ASSIST COVER Specify Depth Below

DESCRIPTION	NOMINAL SIZE W x L x D	LOAD RATING	ANSI TIER	PART NUMBER	APPROX. WEIGHT	PALLET QTY.
Vault & Cover Assembly	48" x 96" x 48"	20K	15	A6001449TAP48MT	1990 lbs.	1

- Vaults are Open Bottom, also available with Split Base or Solid Bottoms.
- For sizes not shown please contact Armorcast Products for more information.

www.armorcastprod.com

Tel: (818) 982-3600 Fax: (818) 982-7742



48" x 96" VAULT ASSEMBLY

STANDARD DIMENSIONS / TORSION ASSIST

ARMORCAST PRODUCTS COMPANY

POLYMER CONCRETE

A6001449MT

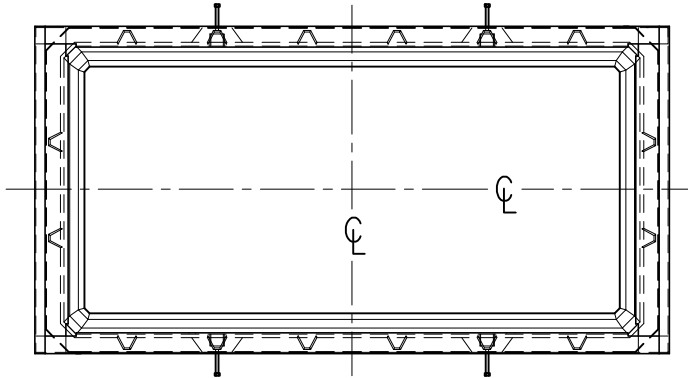

TOP VIEW

SAFETY PIN & CHAIN
FOR OPEN POSITION
(ONE FOR EACH COVER)

FRAME ADJUST

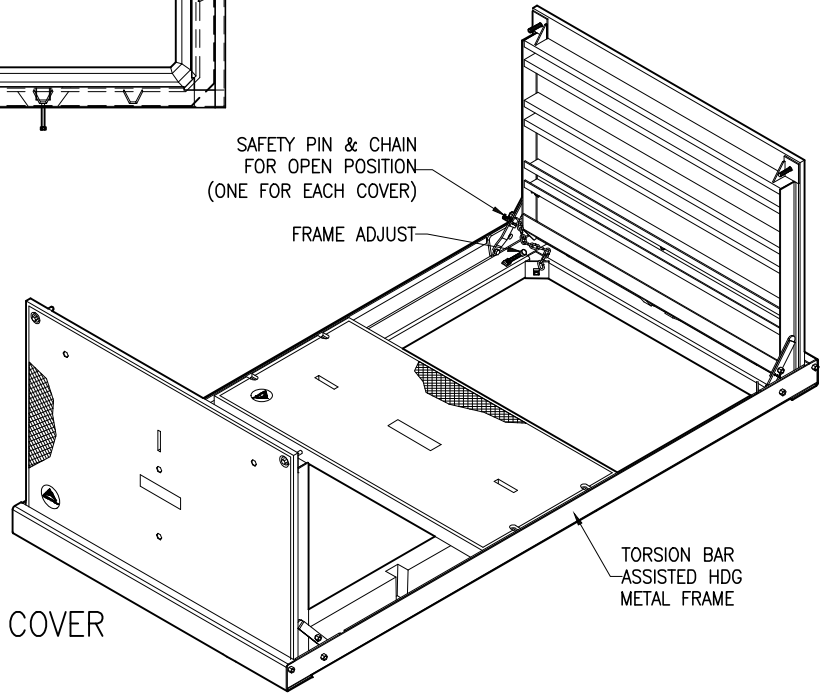

TORSION BAR
ASSISTED HDG
METAL FRAME

TORSION ASSIST COVER

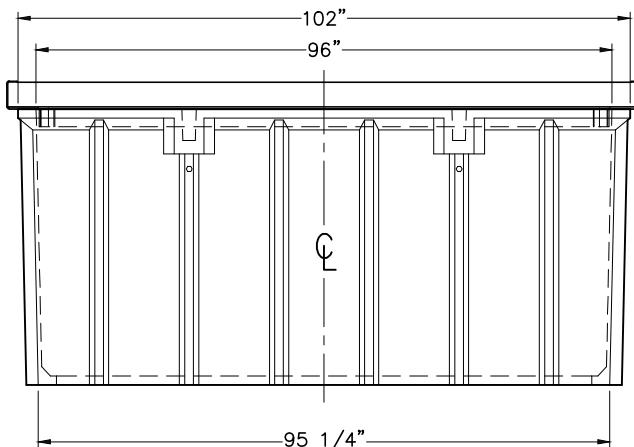

SIDE VIEW

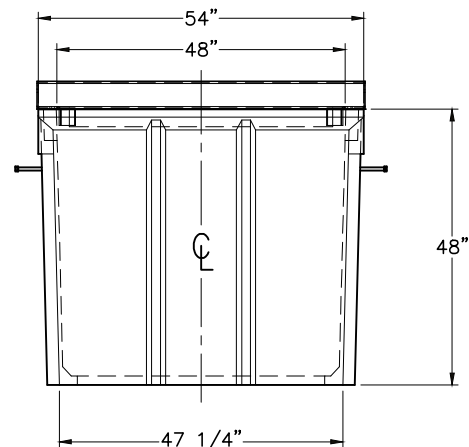

END VIEW

Armorcast Products Company reserves the right to update or discontinue product information at any time without notice.

www.armorcastprod.com

Tel: (818) 982-3600 Fax: (818) 982-7742

POLYMER CONCRETE
VAULTS & MANHOLE